

WPANT10022

915 MHz PIFA Antenna

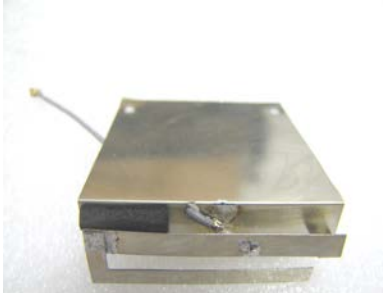

WPANT10022-C2D

3" micro co-ax with IPX MHF

Note: Different cable and connector style requests can be accommodated.

Application

This is a 900 MHz surface-independent antenna in the sense that it will work the same whether it is installed on a metallic or a non-metallic surface.

We can assist your engineers to optimize mounting positions for these antennas in your specific application and can further assist to trouble shoot system integration issues such as TRP/TIS and FCC requirements. We specialize in developing customized Antenna solutions. Please contact sales@worldproducts.com with your specific application requirements.

Electrical Properties

Operating Frequency	900 – 930 MHz
Approximate Antenna Impedance [Ω]	50 Ω
VSWR (Typical)	< 2:1
Peak Gain [dBi] (Typical)	<i>Device and Application dependent</i>
Efficiency [%] (Typical)	<i>Device and Application dependent</i>
Polarization	Linear
Pattern	Omni-directional

Mechanical / Environmental Properties

Antenna Dimensions	1.9" x 1.8" x 0.6" (47.75mm x 46.5mm x 14.5mm)
Antenna Color	Silver
Operating / Storage Temperature	-40°C to +125°C
Environmental	Meets standards for UL 94V-0
Hazardous Materials	RoHS Compliant

Pictures (3D Drawing)

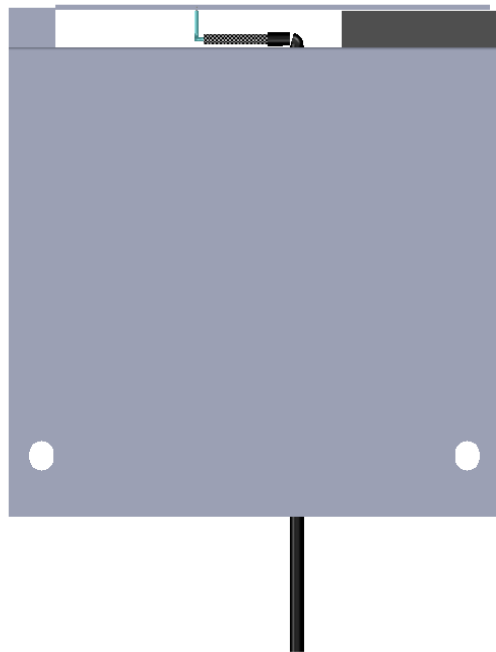
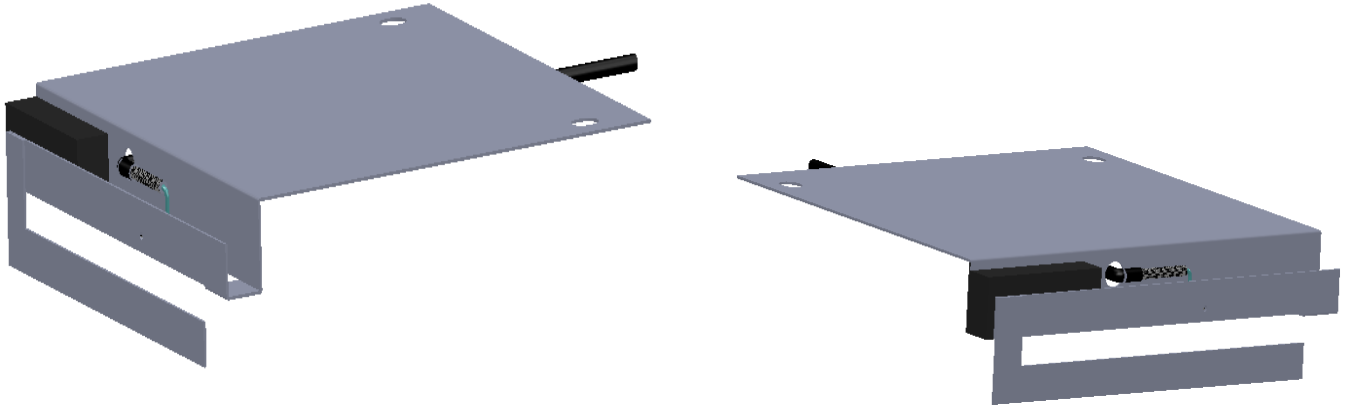

VSWR

